



# DAVIDSON UNITED METHODIST CHURCH

## SUNDAY MORNING CLASS SCHEDULE

**FALL 2009**  
updated 10-18-09

<b>CHILDREN &amp; YOUTH</b>	<b>8:15 a.m.</b>	<b>9:30 a.m.</b>	<b>11:00 a.m.</b>
INFANTS (non-mobile)	115	113	113
CRAWLERS (crawling)	115	115	115
YOUNG WALKERS (born after 8/31/08)	112	117	117
TODDLERS I (3/1/08 - 8/31/08)	112	112	112
TODDLERS II (9/1/07 - 2/28/08)	112	122	122
YOUNGER TWOS (3/1/07 - 8/31/07)	112	114	114
OLDER TWOS (9/1/06 - 2/28/07)	112	116	114
YOUNGER THREES (3/1/06 - 8/31/06)	112	121	121
OLDER THREES (9/1/05 - 2/28/06)	112	123A	121
YOUNGER FOURS (3/1/05 - 8/31/05)	112	118	118
OLDER FOURS (9/1/04 - 2/28/05)	112	120	118
KINDERGARTEN (and 5's in Pre-K)	Worship	124 and 125	G1
GRADE 1	Worship	G1 and G2	G1
GRADE 2	Worship	201 and 203	CHAPEL second and third Sundays each month  Worship first and fourth Sundays each month
GRADE 3	Worship	205 and 212	
GRADE 4	Worship	202/204	
GRADE 5	Worship	206/208	
GRADE 6	Worship	216/218	Worship
GRADE 7	Worship	214	Worship
GRADE 8	Worship	210	Worship
GRADE 9	Worship	Molly McKay Youth House	Worship
GRADE 10	Worship	Molly McKay Youth House	Worship
GRADE 11	Worship	Molly McKay Youth House	Worship
GRADE 12	Worship	Molly McKay Youth House	Worship

### ADULT

BIBLE STUDY CLASS		217	
BILL HIGHT CLASS		222	
FAITH IN ACTION		213	
JOURNEY.COM (Couples on a Mission)		215	
LIFE APPLICATIONS CLASS		Congregational Care House	
NAVIGATORS CLASS		Town Hall	
PAIRS IN PARTNERSHIP CLASS		209	
SHALOM CLASS		220	
BOOMER CLASS		211	
YOUNG ADULTS			214
YOUNG FAMILIES		Purcell Room	

**\* Main Level \***

Hwy 115/Main Street

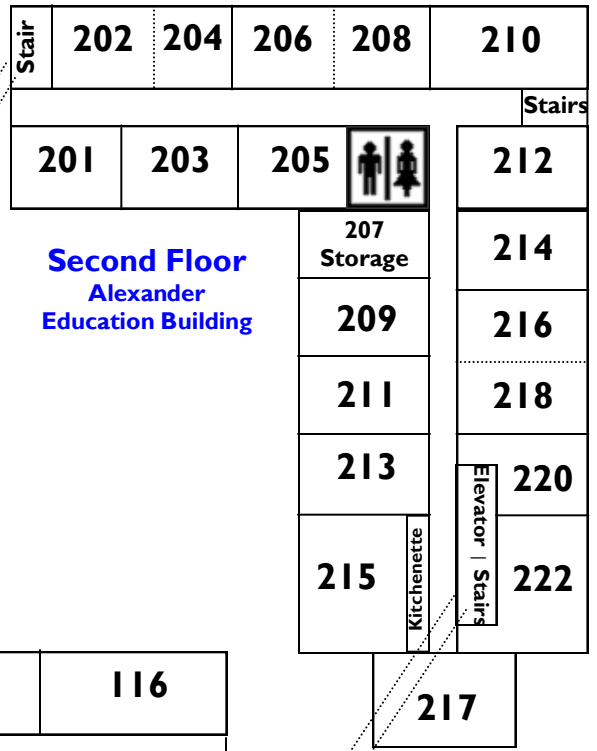
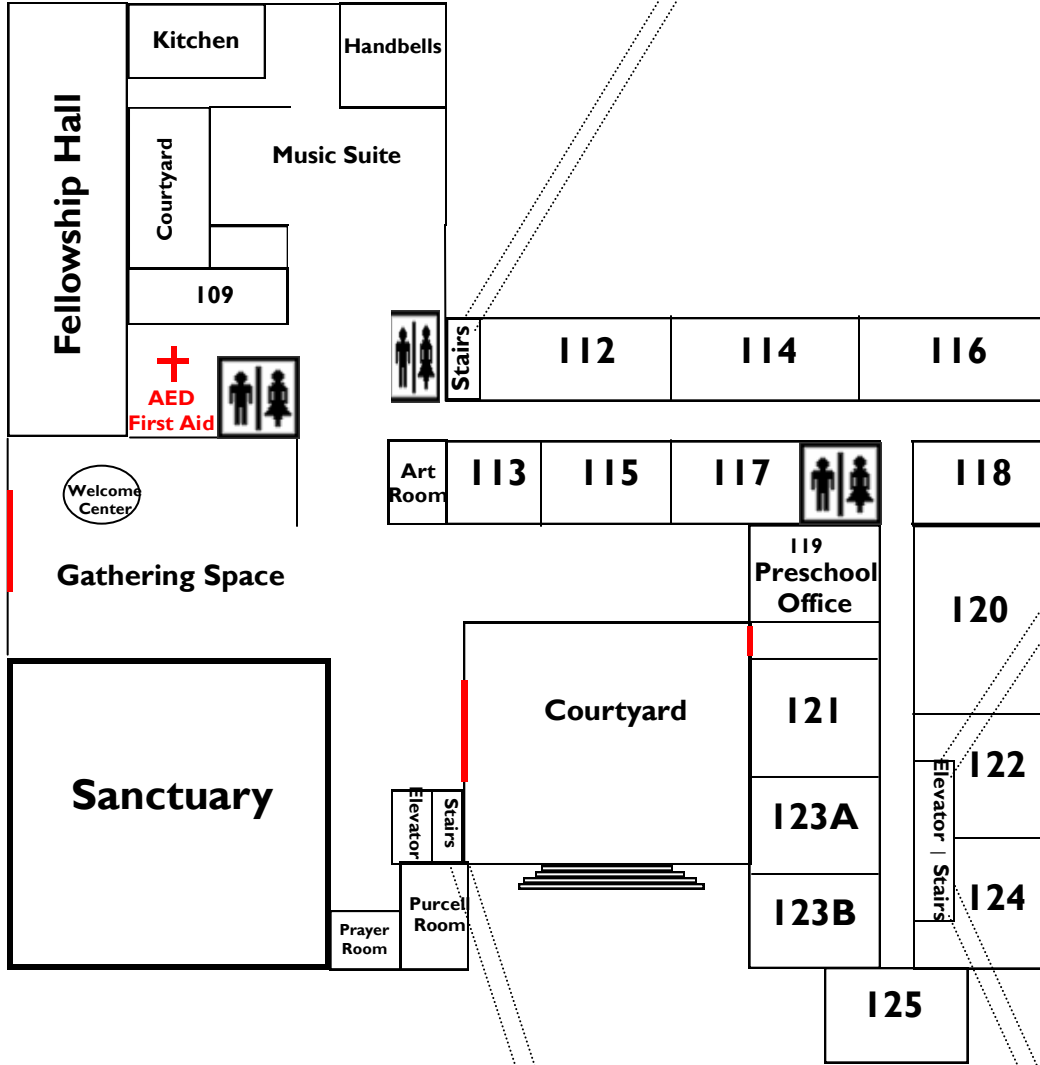

**Ground Level/Parking Lot**

