



DAVIDSON UNITED METHODIST CHURCH SUNDAY MORNING CLASS SCHEDULE

FALL 2010

Updates to birthdates and room locations are noted in blue

CHILDREN & YOUTH	8:15 a.m.	9:30 a.m.	11:00 a.m.
INFANTS (non-mobile)	115	113	113
CRAWLERS (crawling)	115	115	115
YOUNG WALKERS (born after 8/31/09)	112	117	117
TODDLERS I (3/1/09 - 8/31/09)	112	112	112
TODDLERS II (9/1/08 - 2/28/09)	112	122	122
YOUNGER TWOS (3/1/08 - 8/31/08)	112	114	114
OLDER TWOS (9/1/07 - 2/29/08)	112	116	114
YOUNGER THREES (3/1/07 - 8/31/07)	112	121	118
OLDER THREES (9/1/06 - 2/28/07)	112	123A	118
YOUNGER FOURS (3/1/06 - 8/31/06)	112	118	118
OLDER FOURS (9/1/05 - 2/28/06)	112	120	118
KINDERGARTEN (and 5's in Pre-K)	Worship	124 and 125	G1
GRADE 1	Worship	G1 and G2	<p>Jesus the Rock "LIVE!" * Grades 1-5 *</p> <p>Worship FIRST Sunday of each month in the Sanctuary; Meet in CHAPEL all other Sundays of the month.</p>
GRADE 2	Worship	201 and 203	
GRADE 3	Worship	205 and 206 / 208	
GRADE 4	Worship	202/204	
GRADE 5	Worship	212	
GRADE 6	Worship	216/218	Worship
GRADE 7	Worship	214	Worship
GRADE 8	Worship	210	Worship
GRADE 9	Worship	Molly McKay Youth House	Worship
GRADE 10	Worship	Molly McKay Youth House	Worship
GRADE 11	Worship	Molly McKay Youth House	Worship
GRADE 12	Worship	Molly McKay Youth House	Worship
ADULT			
BIBLE STUDY CLASS		217	
BILL HIGHT CLASS		222	
FAITH IN ACTION		213	
JOURNEY.COM		215	
LIFE APPLICATIONS CLASS		Congregational Care House	
NAVIGATORS CLASS		Town Hall	
PAIRS IN PARTNERSHIP CLASS		209	
SHALOM CLASS		220	
YOUNG FAMILIES		Purcell Room	
SUNDAY SHORTS		211 Sept. 12, 19, 26, Oct. 3, 10, 17 Oct. 24, 31, Nov. 7, 14 Dec. 5, 12, 19, 26	

*** Main Level ***

Hwy 115/Main Street

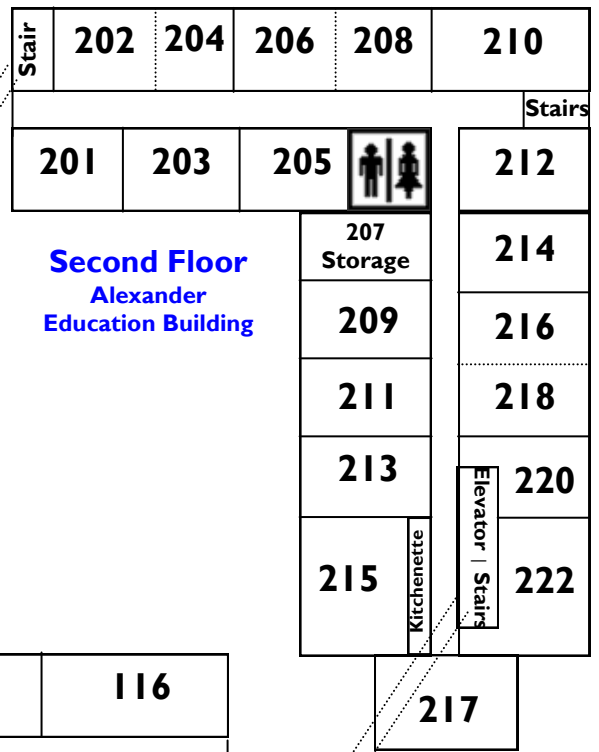
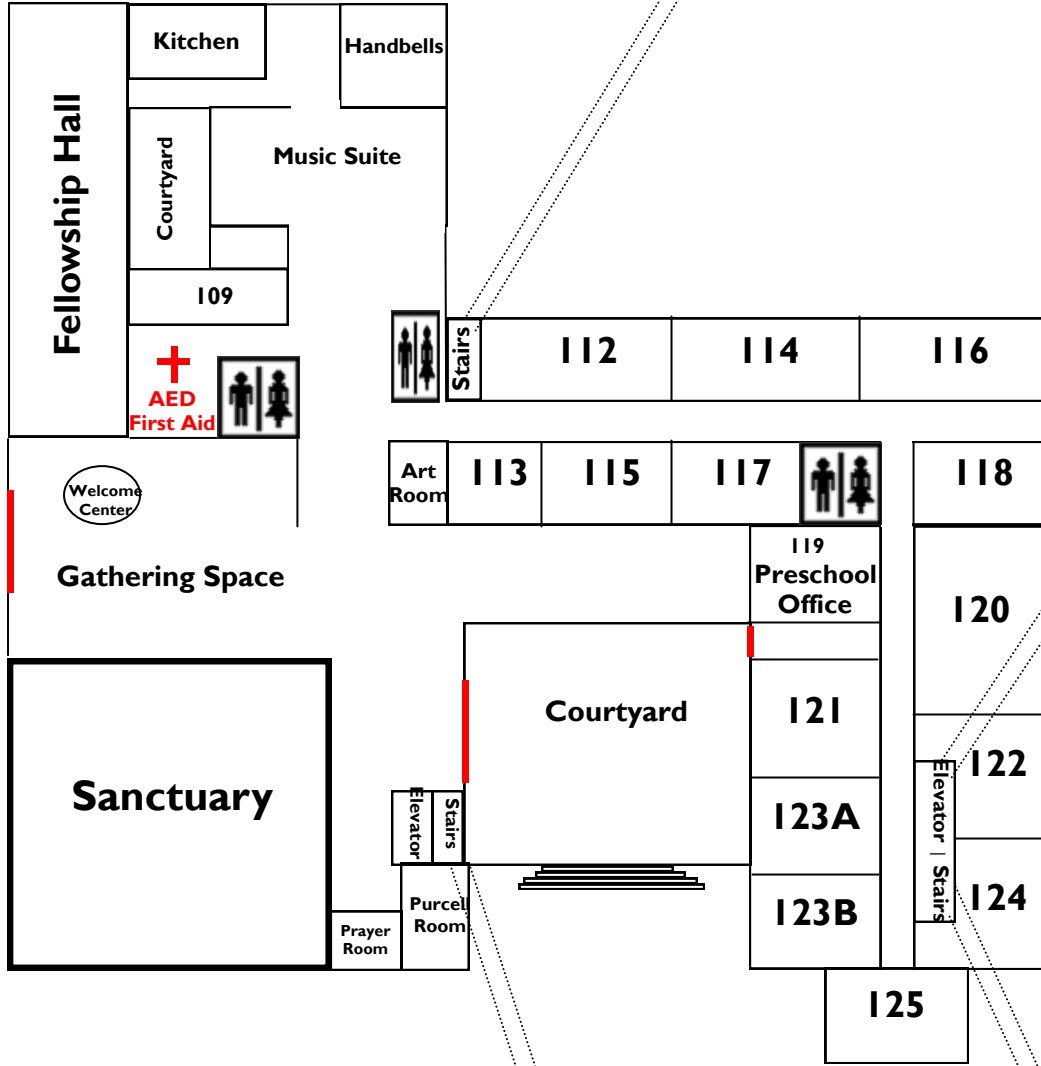

**Second Floor
Alexander
Education Building**



Ground Level

